

**CAVALIER DRAWING:**

1. Centered
2. Dimensioned
3. Drawn full size

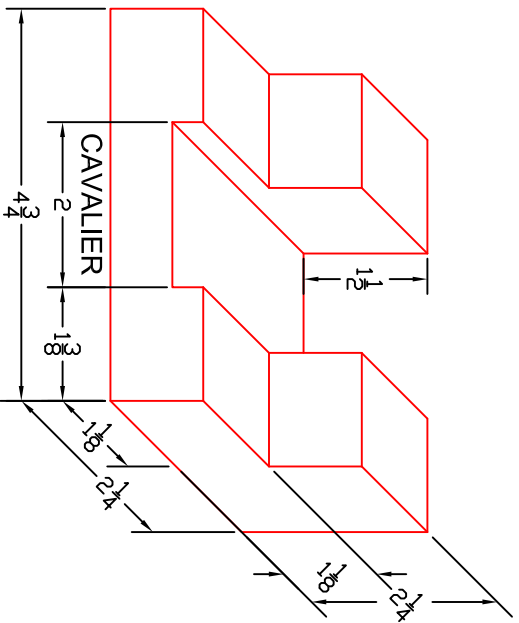

**CABINET DRAWING:**

1. Centered
2. Not dimensioned
3. Width is drawn half size  
Ex: 2" dimension is drawn 1"

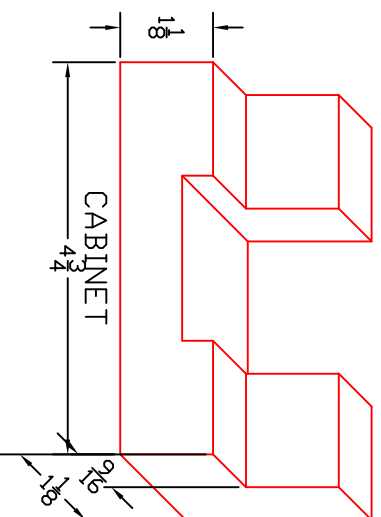

The dimensions drawn are just to show you the nature of the drawing and ARE NOT TO BE DRAWN ON THIS VIEW.

NORTHERN HIGHLANDS REGIONAL HIGH SCHOOL			
TOLERANCE	TECHNICAL DRAWING 2		
DECIMAL	SCALE	MATERIAL	DRAWN BY:
FULL	FULL		A. BOYAJIAN
FRACTION	TITLE: OBLIQUE-HOLDER		
1/64	DATE	DRAWING NUMBER	
ANGULAR	11/28/05	CAD 5	